

# DS-2CE1582P(N)-IR1(IR3)

## 600 TVL DIS IR Bullet Camera



### Key features

- 1/3" DIS
- Min. illumination: 0.1 Lux @ F1.2 (0 Lux with IR)
- True Day/Night
- 3-axis (pan/tilt/rotation) positioning
- Wide operating temperature range
- IP66 rating
- 20m/40m IR Distance

### Dimensions

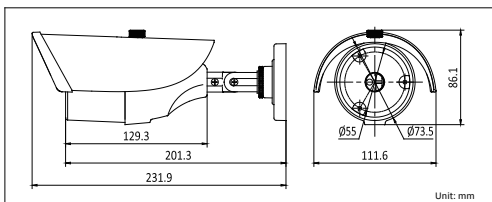

DS-2CE1582P(N)-IR1(IR3)	
<b>Camera</b>	
Image sensor	1 / 3" DIS
Signal system	PAL / NTSC
Effective pixels	720(H)×480(V)
Min. illumination	0.1Lux @ (F1.2,AGC ON),0 Lux with IR 0.2Lux @ (F1.8,AGC ON),0 Lux with IR
Shutter time	PAL: 1 / 25 s to 1 / 15,000 s NTSC: 1 / 30 s to 1 / 15,000 s
Lens	"-IR1" series: 3.6mm @ F1.8 (2.8mm, 6mm optional), Angle of view: 70° (3.6mm) "-IR3" series: 12mm @ F1.8 (3.6mm, 6mm, 8mm, 16mm optional), Angle of view: 22.72° (12mm)
Lens Mount	M12
Angle Adjustment	Pan: 0 - 360°, Tilt: 0 - 90°, Rotation: 0 - 360°
Day & Night	IR cut filter with auto switch
Horizontal Resolution	600 TVL
Synchronization	Internal synchronization
Video Output	1Vp-p composite output (75 Ω / BNC)
S / N Ratio	More than 52 dB
<b>General</b>	
Operating conditions	-40 °C ~ 60 °C (-40 °F ~ 140 °F) Humidity 90% or less (non-condensing)
Power supply	12 VDC ± 10%
Power consumption	"-IR1" series: 6.5W MAX "-IR3" series: 7.5W MAX
Housing	Weather-proof IP66-rated
IR range	"-IR1" series: Approx. 10 to 20 meters "-IR3" series: Approx. 30 to 40 meters
Dimensions	111.6 × 86.1 × 231.9 mm(4.39" × 3.39" × 9.13")
Weight	1000 g (2.20 lbs)

### Available models

PAL: DS-2CE1582P-IR1 , DS-2CE1582P-IR3  
NTSC: DS-2CE1582N-IR1, DS-2CE1582N-IR3